



# TCO

---



**Caratteristiche:** i torrini centrifughi a scarico orizzontale della serie TCO sono realizzati in lamiera di ferro verniciata a polvere con girante in acciaio zincato. Essi rappresentano una soluzione di massima funzionalità e silenziosità per piccoli e medi impianti di estrazione aria. La grande semplicità di installazione privilegia la loro applicazione in tutte le situazioni di aspirazione aria non polverosa.

**Characteristics:** the centrifugal roof fans TCO series are made of iron sheet powder-coated with galvanized steel impeller. They represent a solution with maximum functionality low noise level for small and medium air extraction systems. The great simplicity of installation emphasizes their application in all intake air plants with not dusty air.

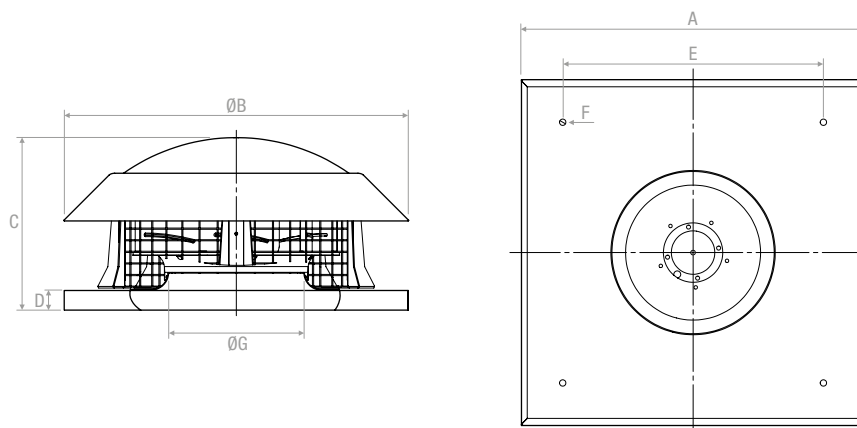

Modello   Model	A	B	C	D	E	F	G
	mm	mm	mm	mm	mm	mm	mm
<b>TCO 225</b>	336	386	212	35	274	11	144
<b>TCO 250</b>	370	386	225	35	290	11	162
<b>TCO 315</b>	454	443	293	40	333	11	198
<b>TCO 355</b>	595	595	285	40	450	11	234
<b>TCO 400</b>	595	685	355	40	450	12	268
<b>TCO 450</b>	664	685	400	40	450	12	303

# TCO

## TABELLA PRESTAZIONI | PERFORMANCE TABLE

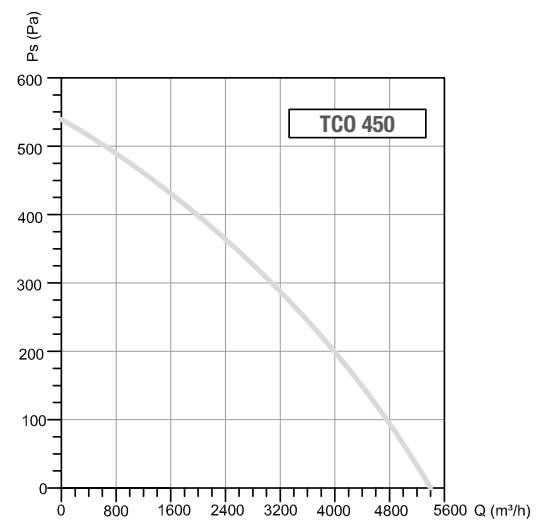
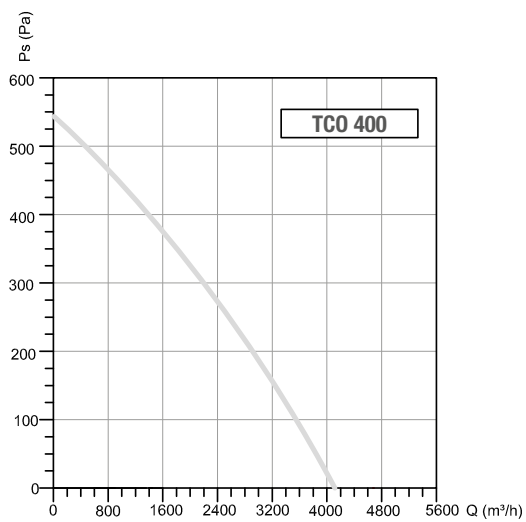
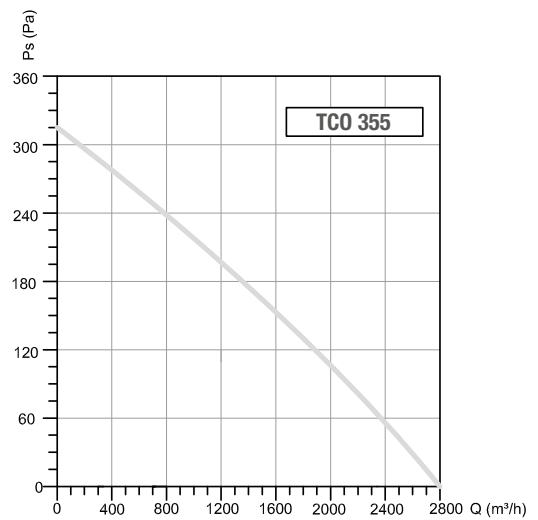
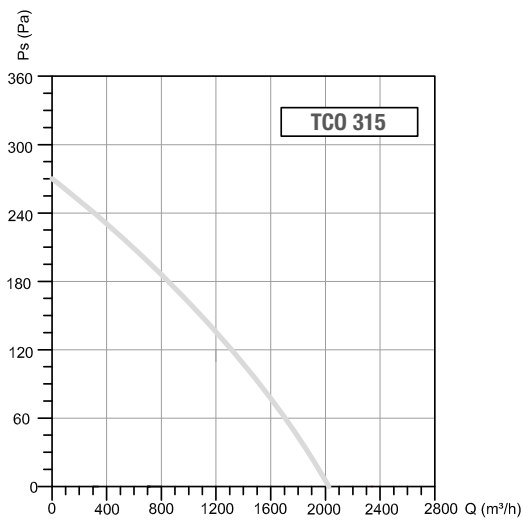
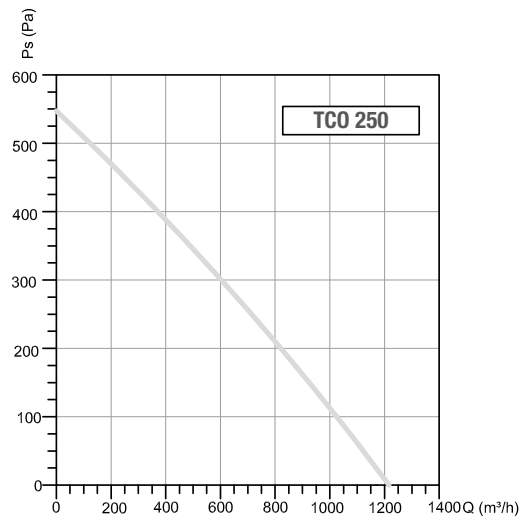
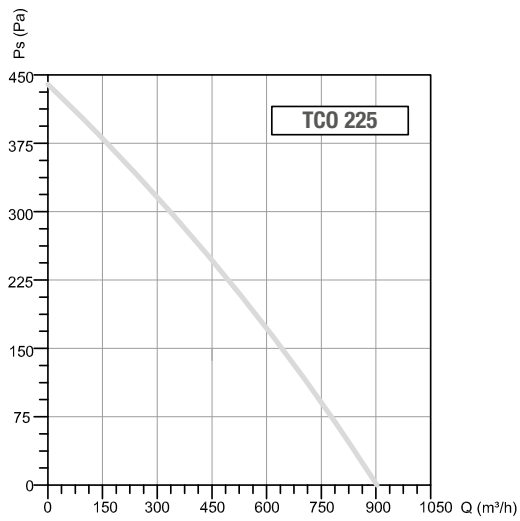

VERSIONI DISPONIBILI | VERSIONS AVAILABLE

stock

TABELLA TECNICA DATI GENERALI | GENERAL TECHNICAL DATA TABLE

Modello Model	Tensione Voltage	Frequenza Frequency	Potenza Power	Corrente Current	Classe isolamento Insulation class	Potenza sonora Sound power	Massima temperatura Maximum temperature	Velocità Speed	Regolatore Regulator	Peso Weight
	Volt	Hz	W	A		dB(A)	°C	RPM		Kg
<b>TCO 225</b>	230	50	130	0,6	IP44	73	40	2750	RC2A	7
<b>TCO 250</b>	230	50	190	0,85	IP44	75	40	2800	RC2A	8
<b>TCO 315</b>	230	50	160	0,8	IP44	70	40	1450	RC2A	12,8
<b>TCO 355</b>	230	50	240	1,1	IP44	69	40	1400	RC2A	18
<b>TCO 400</b>	230	50	380	1,65	IP44	74	40	1380	RC2A	22
<b>TCO 450</b>	230	50	620	2,8	IP44	75	40	1370	RC5A	28

## ACCESSORI | ACCESSORIES

Codice | Code

RC2A

RC5A

