



# GRAI100

---

**Caratteristiche:** griglie di ripresa industriali ad alette fisse inclinate di 45° passo 100 mm.

**Costruzione:** alluminio anodizzato.

**Impiego:** a parete, per presa aria esterna o espulsione.

**Fissaggio:** con clips o viti frontali a richiesta.

**Accessori:**

- Serranda di taratura in acciaio zincato con alette a movimento contrapposto.
- Controtelaio di montaggio in lamiera di acciaio zincata.
- Rete antivolatile.
- Serranda di sovrappressione a gravità.

**Characteristics:** industrial return air grilles with fixed and 45° inclined bars 100 mm pitch.

**Finishing:** anodized aluminium.

**Utilization:** for wall installation and for external air intake or exhaust air flow.

**Fixing:** by clips or frontal screws on request.

**Accessories:**

- Calibration damper made of galvanized steel and fins with opposite movement.
- Mounting counterframes made of galvanized steel sheet.
- Bird screen.
- Overpressure damper.

## MODELLI | MODELS

<b>GRAI100</b>	Griglia di ripresa passo 100 mm (standard)   Aluminium return grille 100 mm between bars (standard)
<b>GRAI100R</b>	Griglia di ripresa passo 100 mm in alluminio con rete antivolatile   Aluminium return grille 100 mm between bars with bird mesh
<b>GRAI100RZ</b>	Griglia di ripresa passo 100 mm in alluminio con rete anti insetto (zanzariera) Aluminium return grille 100 mm between bars with insect screen
<b>GRAI100RSS</b>	Griglia di ripresa passo 100 mm in alluminio con rete antivolatile e serranda di sovrappressione a gravità Aluminium return grille 100 mm between bars with bird mesh and overpressure damper

## ESECUZIONI SU RICHIESTA | AVAILABLE ON REQUEST

Griglia completa di tegolo anti pioggia +TEG +5% AUM | Grille with rain-proof panel +TEG +5% INCREASE

## ACCESSORI | ACCESSORIES

<b>SCAI</b>	Serranda di taratura ad alette con movimento contrapposto   Opposed blade damper
<b>CTP</b>	Controtelaio di fissaggio in lamiera d'acciaio zincata   Counterframe in galvanised steel sheet profile section
<b>PBZ</b>	Plenum di raccordo   Connecting plenum

## VERNICIATURA | PAINTING

Colori RAL 9016 opaco, RAL 9010 lucido: + 15% - Altri colori RAL: prezzi a richiesta  
Color RAL 9016 matt, RAL 9010 glossy: + 15% - Different RAL colors: prices on request

## DISEGNI | DRAWINGS

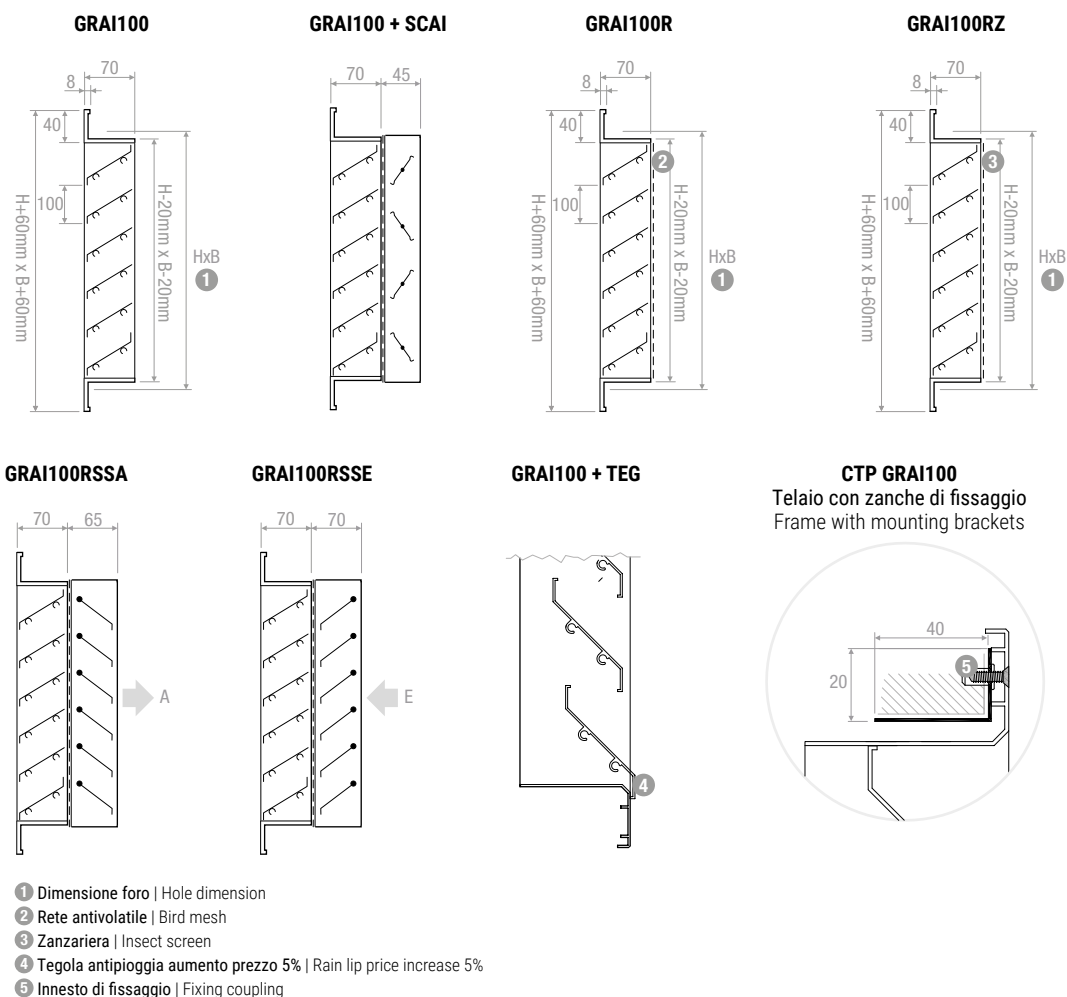

# GRAI100

## FORI | HOLE

GRI

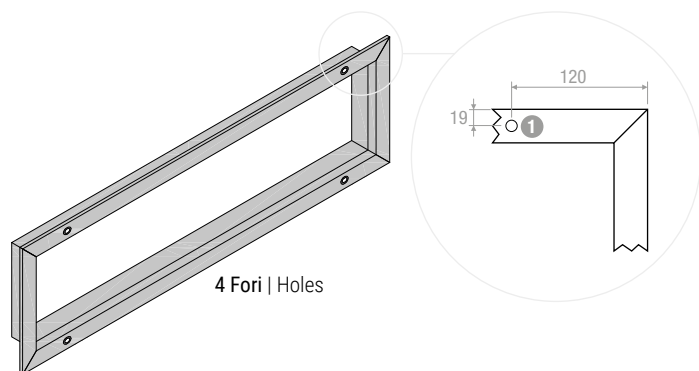

1 Ø 4 Foro svasato | Countersunk hole

## TIPO DI FISSAGGIO | TYPE OF FIXING

Fissaggio con clips  
Fixing with clips

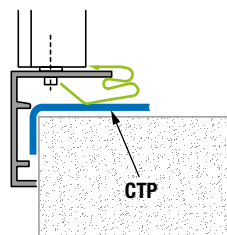

Fissaggio con viti  
Fixing with screws

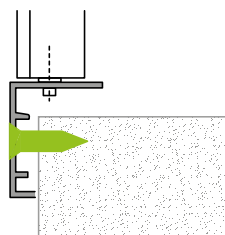

STANDARD

## TABELLA DI SELEZIONE | TECHNICAL DATA







Modello   Model	A <sub>v</sub> [m <sup>2</sup> ]	Q [m <sup>3</sup> /h]		L <sub>wa</sub> [dB(A)]		Dp <sub>t</sub> [Pa]	
		min	max	min	max	min	max
GRAI100 400x400	0,0771	480	970	25	45	5	20
GRAI100 600x400	0,1153	720	1450	25	45	5	20
GRAI100 800x400	0,1535	960	1930	25	45	5	20
GRAI100 1000x400	0,1917	1200	2410	25	45	5	20
GRAI100 1200x400	0,2299	1440	2880	25	45	5	20
GRAI100 1400x400	0,2681	1670	3360	25	45	5	20
GRAI100 1600x400	0,3063	1910	3840	25	45	5	20
GRAI100 1800x400	0,3445	2150	4320	25	45	5	20
GRAI100 2000x400	0,3827	2390	4800	25	45	5	20
GRAI100 400x500	0,1068	670	1340	25	45	5	20
GRAI100 500x500	0,1335	830	1670	25	45	5	20
GRAI100 600x500	0,1602	1000	2010	25	45	5	20
GRAI100 800x500	0,2135	1330	2680	25	45	5	20
GRAI100 1000x500	0,2669	1670	3350	25	45	5	20
GRAI100 1200x500	0,3203	2000	4020	25	45	5	20
GRAI100 1400x500	0,3736	2330	4690	25	45	5	20
GRAI100 1600x500	0,4270	2670	5360	25	45	5	20
GRAI100 1800x500	0,4804	3000	6030	25	45	5	20
GRAI100 2000x500	0,5338	3330	6700	25	45	5	20
GRAI100 400x600	0,1365	850	1710	25	45	5	20
GRAI100 600x600	0,2050	1280	2570	25	45	5	20
GRAI100 800x600	0,2735	1710	3430	25	45	5	20
GRAI100 1000x600	0,3421	2140	4290	25	45	5	20
GRAI100 1200x600	0,4106	2560	5150	25	45	5	20
GRAI100 1400x600	0,4792	2990	6010	25	45	5	20
GRAI100 1600x600	0,5477	3420	6870	25	45	5	20
GRAI100 1800x600	0,6162	3850	7730	25	45	5	20
GRAI100 2000x600	0,6848	4270	8590	25	45	5	20
GRAI100 400x800	0,1958	1220	2460	25	45	5	20
GRAI100 600x800	0,2947	1840	3700	25	45	5	20
GRAI100 800x800	0,3936	2460	4940	25	45	5	20
GRAI100 1000x800	0,4924	3070	6180	25	45	5	20
GRAI100 1200x800	0,5913	3690	7420	25	45	5	20
GRAI100 1400x800	0,6902	4310	8660	25	45	5	20
GRAI100 1600x800	0,7890	4920	9900	25	45	5	20
GRAI100 1800x800	0,8879	5540	11140	25	45	5	20
GRAI100 2000x800	0,9868	6160	12380	25	45	5	20
GRAI100 400x1000	0,2552	1590	3200	25	45	5	20
GRAI100 600x1000	0,3844	2400	4820	25	45	5	20
GRAI100 800x1000	0,5136	3210	6440	25	45	5	20
GRAI100 1000x1000	0,6428	4010	8070	25	45	5	20
GRAI100 1200x1000	0,7720	4820	9690	25	45	5	20
GRAI100 1400x1000	0,9012	5620	11310	25	45	5	20
GRAI100 1600x1000	1,0304	6430	12930	25	45	5	20
GRAI100 1800x1000	1,1596	7240	14550	25	45	5	20
GRAI100 2000x1000	1,2888	8040	16170	25	45	5	20
GRAI100 400x1200	0,3146	1960	3950	25	45	5	20
GRAI100 600x1200	0,4741	2960	5950	25	45	5	20
GRAI100 800x1200	0,6336	3950	7950	25	45	5	20
GRAI100 1000x1200	0,7932	4950	9950	25	45	5	20
GRAI100 1200x1200	0,9527	5950	11950	25	45	5	20
GRAI100 1400x1200	1,1122	6940	13950	25	45	5	20
GRAI100 1600x1200	1,2718	7940	15960	25	45	5	20
GRAI100 1800x1200	1,4313	8930	17960	25	45	5	20
GRAI100 2000x1200	1,5908	9930	19960	25	45	5	20
GRAI100 400x1500	0,4036	2520	5060	25	45	5	20
GRAI100 600x1500	0,6086	3800	7640	25	45	5	20
GRAI100 800x1500	0,8137	5080	10210	25	45	5	20
GRAI100 1000x1500	1,0187	6360	12780	25	45	5	20
GRAI100 1200x1500	1,2237	7640	15350	25	45	5	20
GRAI100 1400x1500	1,4288	8920	17930	25	45	5	20
GRAI100 1600x1500	1,6338	10200	20500	25	45	5	20
GRAI100 1800x1500	1,8388	11480	23070	25	45	5	20
GRAI100 2000x1500	2,0439	12760	25640	25	45	5	20
GRAI100 2000x1600	2,1949	13700	27540	25	45	5	20
GRAI100 2000x2000	2,7989	17470	35120	25	45	5	20

# GRAI100

VERSIONI DISPONIBILI | VERSIONS AVAILABLE

GRI

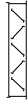
						
BxH	GRAI100	GRAI100R	GRAI100RZ	GRAI100RSS	SCAI	CTP
mm						
400x400						
500x400						
600x400						
800x400						
1000x400						
1200x400						•
1400x400						•
1600x400						•
1800x400						•
2000x400						•
400x500						
500x500						
600x500						
800x500						
1000x500						
1200x500						•
1400x500						•
1600x500						•
1800x500						•
2000x500						•
400x600						
600x600						
800x600						
1000x600						
1200x600						•
1400x600						•
1600x600						•
1800x600						•
2000x600						•
400x800						
600x800						
800x800						
1000x800						
1200x800						•
1400x800						•
1600x800						•
1800x800						•
2000x800						•

						
BxH	GRAI100	GRAI100R	GRA100IRZ	GRAI100RSS	SCAI	CTP
mm						
600x1000						
800x1000						
1000x1000						
1200x1000 •						
1400x1000 •						
1600x1000 •						
1800x1000						
2000x1000						
400x1200						
600x1200						
800x1200						
1000x1200						
1200x1200						
1400x1200						
1600x1200						
1800x1200						
2000x1200						
400x1500						
600x1500						
800x1500						
1000x1500						
1200x1500						
1400x1500						
1600x1500						
1800x1500						
2000x1500						
2000x1600						
2000x1800						
2000x2000						

• Rinforzo intermedio | Intermediate reinforcing